



Bits 'n Pieces

34629 Michigan Ave, Wayne, MI 48184
(734) 641-4970

Stitching Half-Square Triangle Squares

© copyright 2020, Julia H. Hale

Blocks #9, #10, #11 and #12 are made with
2 1/2" finished half-square triangle squares.

Creative Grids 9" Seam Guide Tool

UK - www.creativegrids.com
USA - www.creativegridsusa.com
© 2019 Creative Grids
MADE IN USA

creative
grids®
The Original NON-SLIP Ruler

CGRSM19

The Seam Guide is 1/2" wide, with slots down the center to mark 1/4" seam allowances. The back of the tool has grip to hold the tool in place while marking. It is NOT designed to be used with a rotary cutter. Cut the squares (do NOT cut them in half) and layer them right sides together (1). Place the Seam Guide tool corner to corner (2). Mark the center and stitch 1/4" on both sides (3). Cut diagonally in half (4, 5). Or, mark both sides and stitch on the lines (6). Cut and press to make 2 half-square triangle squares.

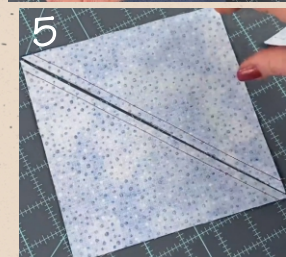

2 1/2" Triangle Paper

Use Triangle Paper to aid in stitching accurate half-square triangle squares. The Triangle Paper stabilizes the bias edges when you sew. Place the 2 fabrics, right sides together. Layer the paper on top (1). Stitch on the lines. After stitching on the lines, cut the paper apart into squares (2). Remove the paper (3), then cut the square diagonally in half and press (4).

Purchase the size of the Triangle Paper to match the finished size of the square.

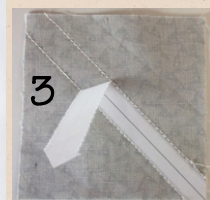
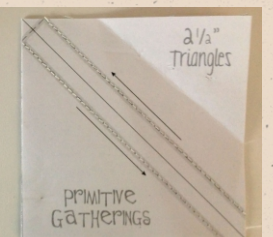
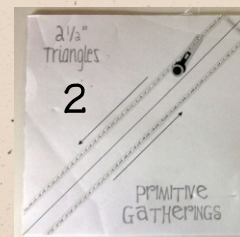
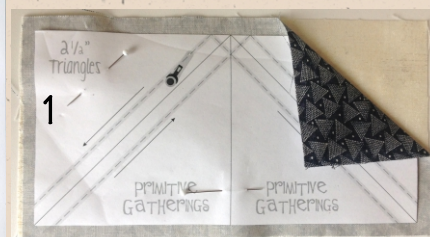

TIPS:

Each paper square yields 2 half-square triangle squares.

Shorten the stitch length to make tearing the paper away easier.

Cut into squares first, then tear away the triangles and then the center section. Finally, cut down the center and press.